

# BUTTON IT! HOW TO SEW ON A BUTTON



**DON'T YOU JUST HATE IT WHEN YOU'RE PUTTING ON YOUR FAVOURITE COAT AND 'POP'; A BUTTON FALLS OFF AND YOU'VE GOT ONE MISSING.**

**HERE'S HOW TO REMEDY THAT COMMON PROBLEM IN SIX SIMPLE STEPS:**

1. Thread a needle so the thread is doubled and about 20cm long. Tie a small knot at the end of the thread.
2. Make a small stitch where you want the button to be placed (make sure you start from the back so that the knot doesn't show).
3. Insert the needle into one of the holes on the button and pull the needle through. Now find a pin or match stick (depending on the thickness of the material) and place this beneath the button as you're sewing. This stops the button from being sewn too tight.

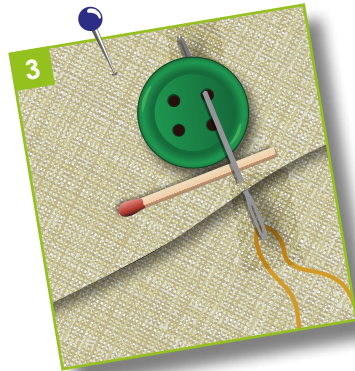

4. Continue to sew stitches through the holes in the button, down into the fabric, and up again.

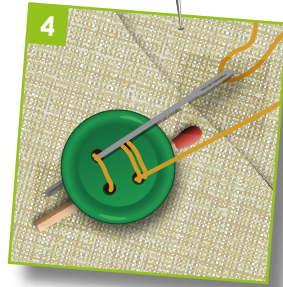

5. When you feel the button is nicely secured, remove the pin or match stick and bring the needle between the garment and the button. Wrap the thread six times around the thread between the button and fabric.

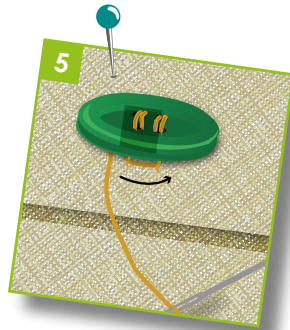

6. Push the needle back through the material so that it's underneath. Secure with a final few stitches and trim off any excess thread with scissors.